

FLOOR PLAN

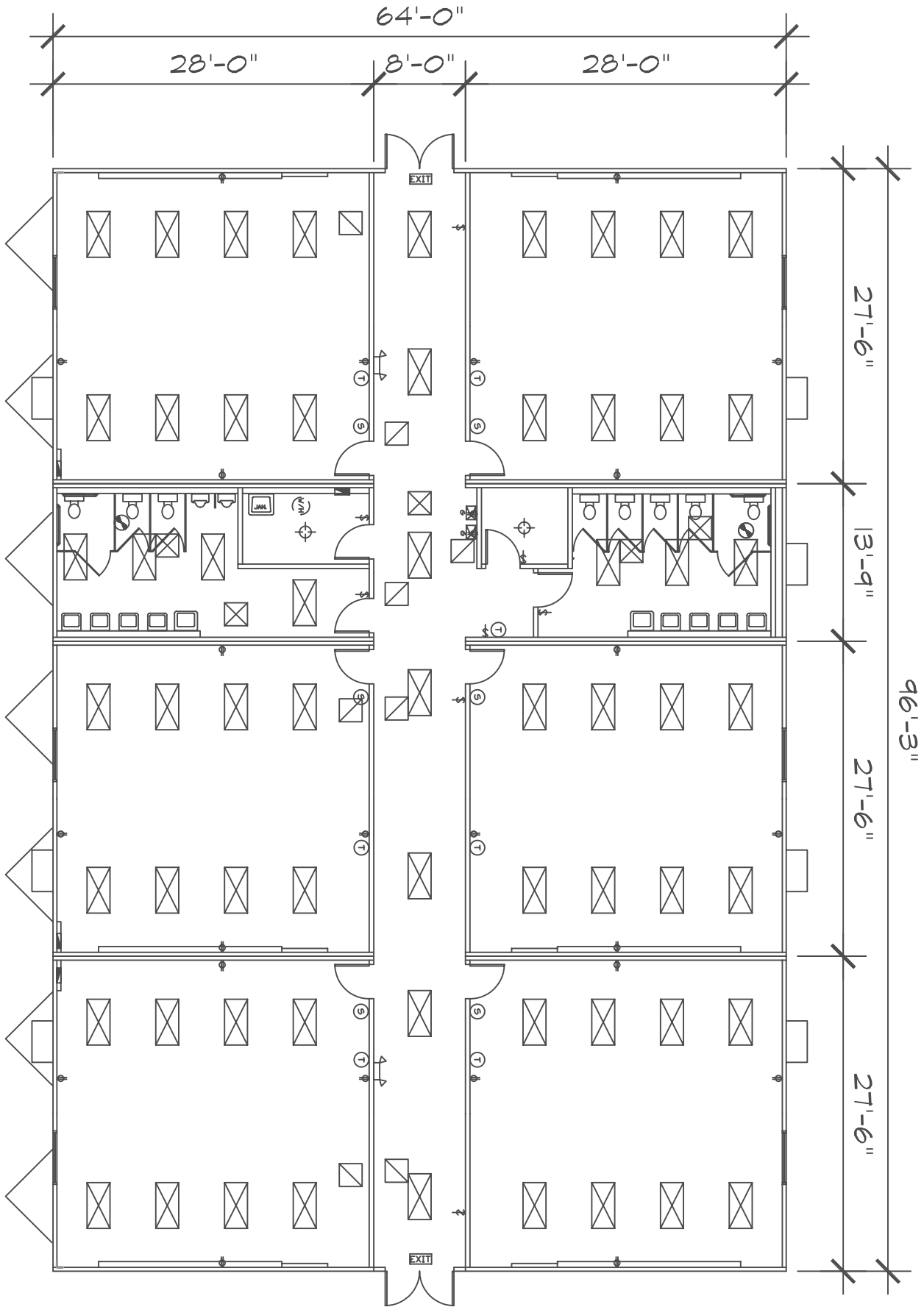

- ☒ 2X4 CEILING MT. FLUORESCENT LIGHT
- ⊕ CEILING MT. INCANDESCENT DRUM LIGHT
- ☒ CEILING MT. EXIT LIGHT WBATTERY PACK
- ☒ DUAL HEAD EMERGENCY LIGHT @ 84" A.F.F.
- ↔ SINGLE POLE SWITCH @ 48" A.F.F.
- ⊙ SENSOR SWITCH @ 48" A.F.F.
- ⊙ 110V DUPLEX RECEPTACLE @ 15" A.F.F.
- ⊙ 110V GFI DUPLEX RECEPT. @ 15" A.F.F.
- ☒ 24X24 CEILING MT. ADJ. SUPPLY AIR DIFFUSER
- ☒ CEILING MT. 24X24 RETURN AIR GRILLE
- ☒ CEILING MT. EXHAUST FAN
- Ⓢ PROGRAMMABLE THERMOSTAT @ 54" A.F.F.

PROJECT: PORTABLE CLASSROOM WING
 SIX CLASSROOMS with RESTROOMS
 LOCATION: PURCHASE or LEASE/RENTAL



MARK	PLAN REVISIONS
▲	
▲	
▲	
▲	
▲	
▲	
▲	

PROJECT NUMBER: 7-30-03
 DRAWN BY: DM
 SHEET NO: A1